



# Shantee Homes Realty LLP

REDEFINING LIFESTYLES  
SINCE 2 DECADES



## SUNSHINE \* ENCLAVE \*

*Elevate Your Living Experience*







**SUNSHINE**  
· ENCLAVE ·

*Elevate Your Living Experience*





# MULTIFARIOUS LUXURY AMENITIES TO CATER TO ALL AGE GROUP



# Royally Lavish. . . AMENITIES

## LIVING & BEDROOM

- Mirror Finished Designer Vitrified/ Porcelano Tile Flooring.
- Decorative Entrance Door With Ultra-modern Lock
- Smooth Finished Wall Acrylic Distemper Paint.
- Power Coated Aluminum Sliding Windows.
- Pop False Ceiling In Hall.

## ELECTRICALS

- Concealed Copper Wiring With Modular Switches.
- Sufficient Electrical Points in All Rooms.
- Safety Features Like MCB/ELCB.
- Concealed Invertor Wiring.

## KITCHEN

- Granite Kitchen/ Marble Platform With Stainless Sink.
- Tiles In Kitchen Upto Beam Level Above Platform.
- Kitchen Trolley & Kitchen Cabinet.

## BATHROOM

- Anti-Skid Rustic Tile Flooring
- Designer Digital Tiles Upto Door Height.
- Branded Plumbing Fittings.
- Branded Sanitary Wares.

## SECURITY

- CCTV Camera in Building Premises.
- Fire Protection System.
- Professionally Managed 24x7 Security.

## BUILDING PROJECT AMENITIES

- Gymnasium.
- Roof Top Amenities Such as Garden, Yoga & Meditation Area, Jogging Track.
- Kids Area/ Senior Citizen Area.
- Hi-Speed Branded Lift.
- Standby Power Backup for Lift, Lights in Common Areas.
- Earthquake Resistant RCC Framed Structure.
- Anti-Termite treatment.
- Spacious & Decorative Entrance Lobby.
- Ample Car Parking.
- Hi-Tech Fire Fighting System.
- Rain Water Harvesting.
- 24 Hours CCTV Surveillance.



EXPERIENCE THE HEIGHT OF LUXURY & LEISURE  
MESMERIZING VIEWS OF LUSH GREENS









# FIRST FLOOR PLAN





# EIGHTH FLOOR PLAN





# TYPICAL FLOOR PLAN

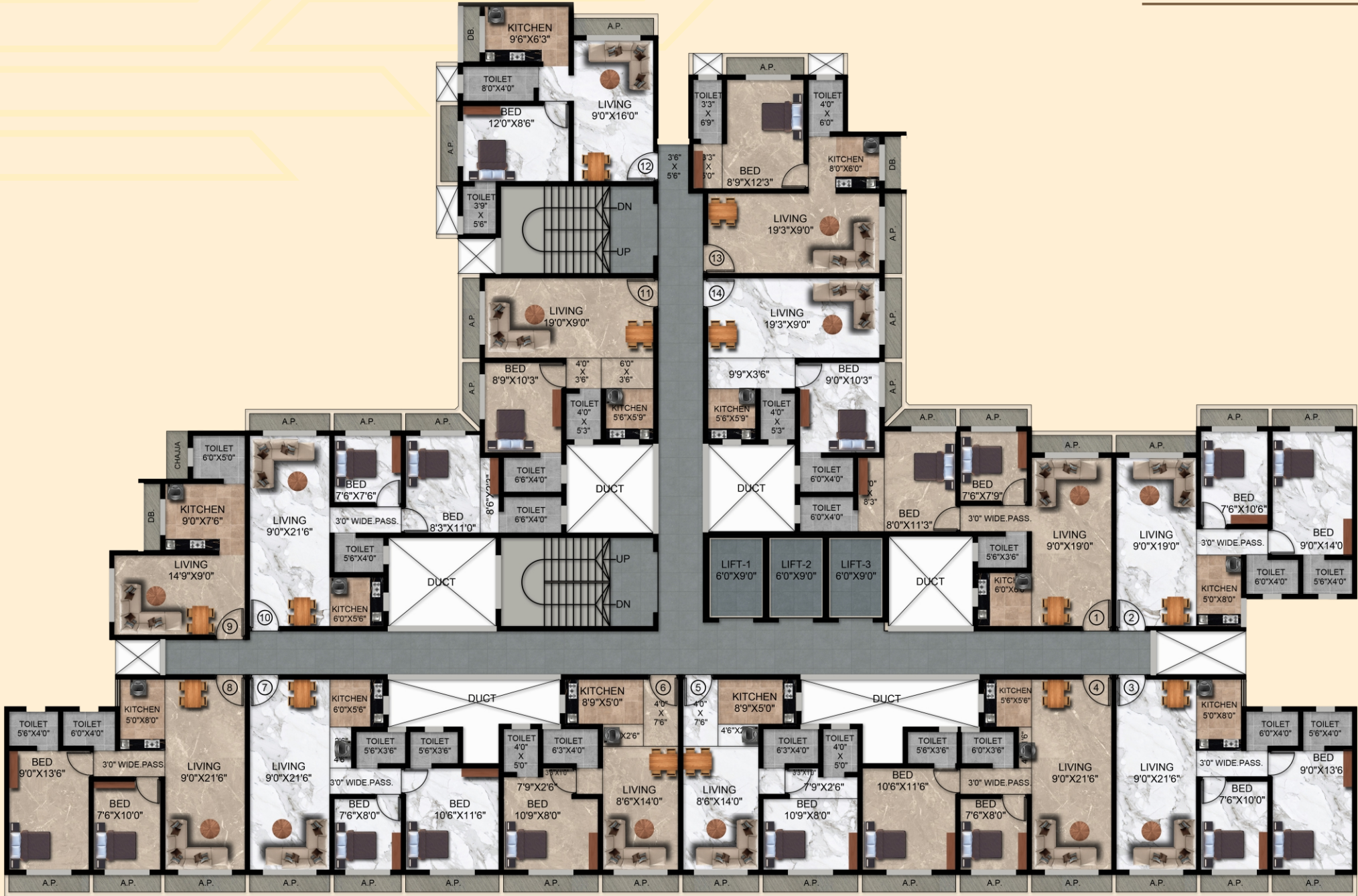



# 1 BHK UNIT PLAN



# 1 BHK ISOMETRIC VIEW



# 2 BHK UNIT PLAN



# 2 BHK ISOMETRIC VIEW



# COMPLETED PROJECTS



ARTISTIC IMPRESSION

**SUNSHINE CITY  
NALASOPARA (E)**



ARTISTIC IMPRESSION

**MEERA AVENUE  
VASAI (E)**



ARTISTIC IMPRESSION

**STERLING HEIGHTS  
VASAI (E)**



ARTISTIC IMPRESSION

**SUNSHINE PALACE  
VASAI (E)**



ARTISTIC IMPRESSION

**MARVEL HEIGHTS  
VASAI (E)**



ARTISTIC IMPRESSION

**SUNSHINE SAPPHIRE  
VASAI (E)**



ARTISTIC IMPRESSION

**ROMAN RESIDENCY  
VASAI (W)**



ARTISTIC IMPRESSION

**SHAMROCK  
RESIDENCY VASAI (W)**



ARTISTIC IMPRESSION

**SARGAM AVENUE  
NAIGAON (E)**



ARTISTIC IMPRESSION

**SARGAM RESIDENCY  
NAIGAON (E)**



ARTISTIC IMPRESSION

**SPANISH VILLA  
NAIGAON (E)**



ARTISTIC IMPRESSION

**ORCHID VILLA  
NAIGAON (E)**



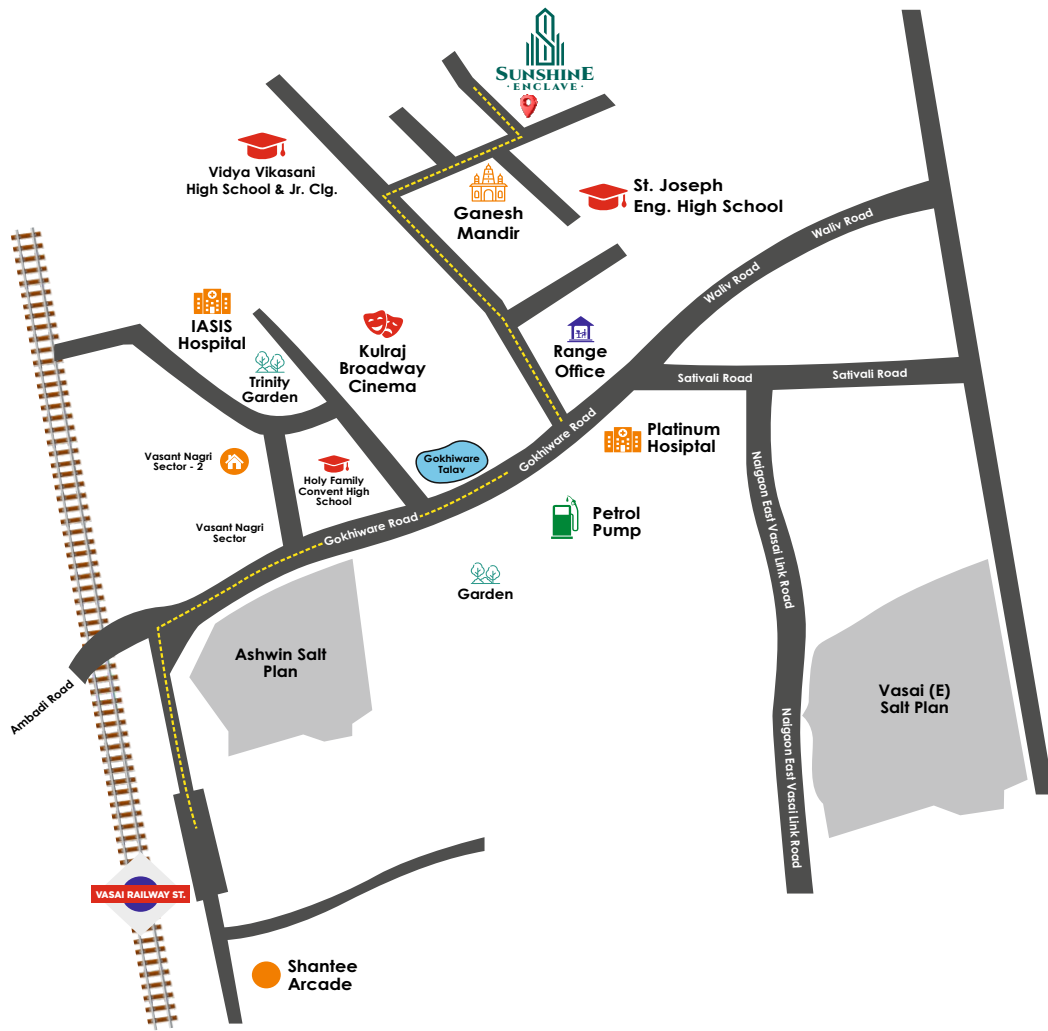

**LOCATION MAP**

**-: SITE OFFICE :-**

**Sunshine Green Park, Nr. Vidya Vikasini High School & Jr. College  
Fatherwadi, Gokhiware, Vasai (E).**

**Contact No.: +91 8446490801 | +91 9699950186**

**-: HEAD OFFICE :-**

**Municipal House No. 904, Ground floor, Sai Shradha Bungalow, Behind Gopal Building,  
Shastri Nagar, Ambadi Road, Vasai (West), Dist.-Palghar - 401202**

**Contact No.: 0250-2331171 | +91 727690900**

**STRUCTURAL CONSULTANT : G.R. CONSULTANTS  
ARCHITECT : EN-CON**

**E-Mail ID: shanteehomes@gmail.com | Website : www.shanteehomes.com**



**MAHARERA NO.: P99000030524**  
Available at <https://maharera.mahaonline.gov.in>